

▶ PX24-12F6 12V 24 Ah

POWER-XTRA



▶ Product Features

Deep Cycle Series	400~600 Cycle Times @100%DOD	
↑ 10% Energy Density Patent negative pasting formula	↓ 50% Grid Corrosion Rare-earth patent alloy	0% Acid stratification Nano silica gel technology

▶ Product Applications



▶ Physical Specifications

Model	Dimensions (mm/inch)				Weight (kg/lbs)	Terminal	Container
	Length	Width	Height	Total Height			
PX24-12F6	178/7.01	77/3.03	170/6.69	170/6.69	6.10/13.4	110	ABS UL94-HB (Optional: FR ABS UL94-V0)

▶ Product Specifications

Nominal Voltage	Rated Capacity 25°C/77°C	Operating Temp. Range	Capacity Effected Temp	Capacity vs Storage Time
12V	25Ah 20hr Rate (1.80V/cell) 22.0Ah 10hr Rate (1.75V/cell) 21.5Ah 5hr Rate (1.75V/cell) 20.0Ah 2hr Rate (1.75V/cell)	Discharge: -15°C~50°C (5°F~122°F) Charge: 0°C~40°C (32°F~104°F) Storage: -15°C~40°C (5°F~104°F) Optimum: 25°C±2°C (77°F±5°F)	40°C (104°F):106% 25°C (77°F):100% 0°C (32°F):85% -15°C (5°F):72%	Three months : 90% Six months : 80% Nine months : 60%

▶ Constant Current Discharge (A)@25°C (77°F)

F.V/Time	30min	45min	1h	2h	3h	4h	5h	6h	8h	10h	20h
1.85V/cell	26.7	19.1	15.1	8.65	6.06	4.68	3.89	3.31	2.58	2.10	1.15
1.80V/cell	27.6	19.6	15.6	8.94	6.19	4.83	4.04	3.44	2.65	2.16	1.25
1.75V/cell	28.5	20.4	16.2	10.0	6.73	5.06	4.29	3.61	2.73	2.20	1.21
1.70V/cell	29.2	20.9	16.7	10.1	6.80	5.18	4.33	3.68	2.79	2.26	1.24
1.67V/cell	29.8	21.6	17.3	10.2	6.90	5.31	4.46	3.76	2.86	2.30	1.25
1.60V/cell	30.6	22.2	17.6	10.5	7.14	5.46	4.52	3.85	2.93	2.37	1.26

▶ Constant Power Discharge (W/cell)@25°C (77°F)

F.V/Time	30min	45min	1h	2h	3h	4h	5h	6h	8h	10h	20h
1.85V/cell	52.2	37.6	29.9	17.2	12.1	9.43	7.84	6.69	5.23	4.27	2.34
1.80V/cell	53.8	38.4	30.7	17.8	12.4	9.69	8.12	6.92	5.35	4.36	2.53
1.75V/cell	55.1	39.9	31.8	19.8	13.4	10.1	8.59	7.23	5.48	4.43	2.44
1.70V/cell	56.2	40.6	32.6	19.8	13.5	10.3	8.62	7.33	5.59	4.52	2.49
1.67V/cell	57.0	41.6	33.6	19.9	13.6	10.5	8.82	7.44	5.66	4.57	2.49
1.60V/cell	58.0	42.4	33.9	20.4	13.9	10.7	8.86	7.56	5.77	4.68	2.51

PX24-12F6

12V 24 Ah

POWER-XTRA

Battery Dimensions(mm)

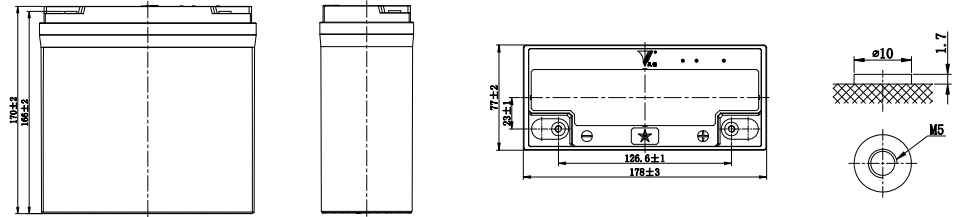

Electrical Characteristics

Discharging Characteristics@25°C(77°F)

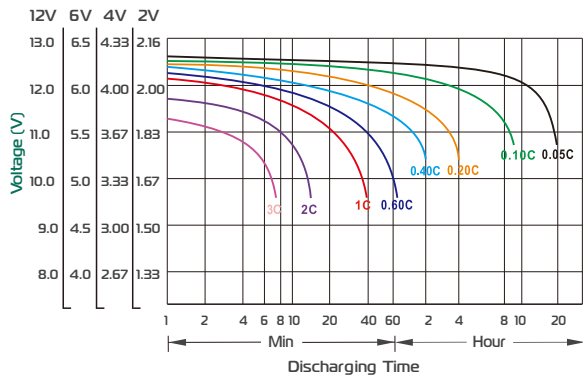

Charging Characteristics@25°C(77°F)

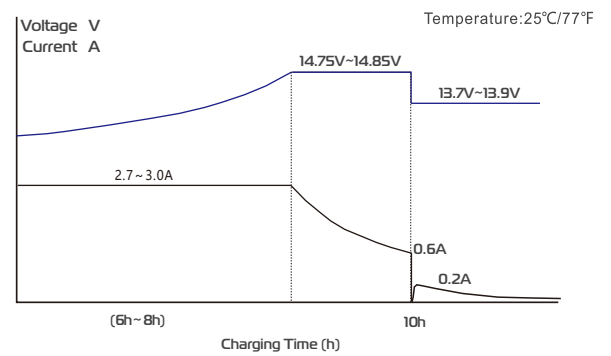

Capacity vs Temperature

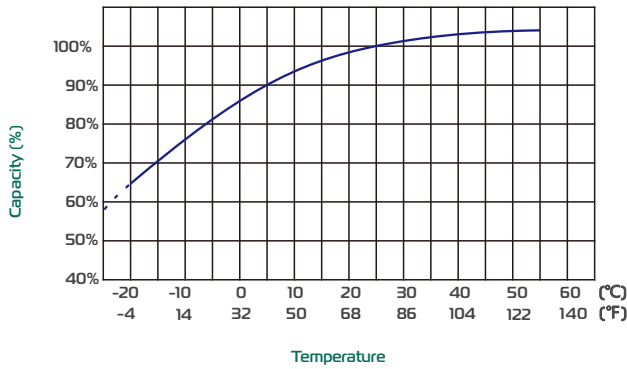

Self-discharge vs Time

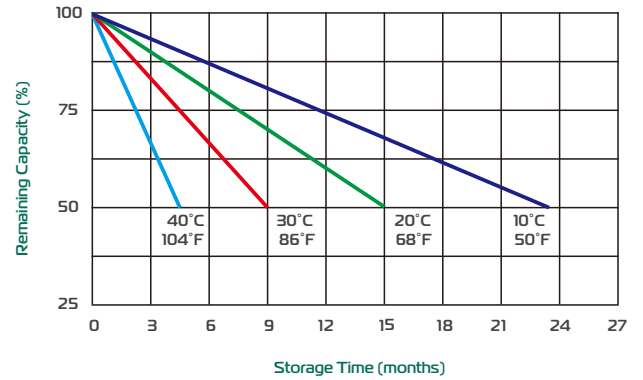

Cycle Life vs Depth of Discharge@25°C(77°F)

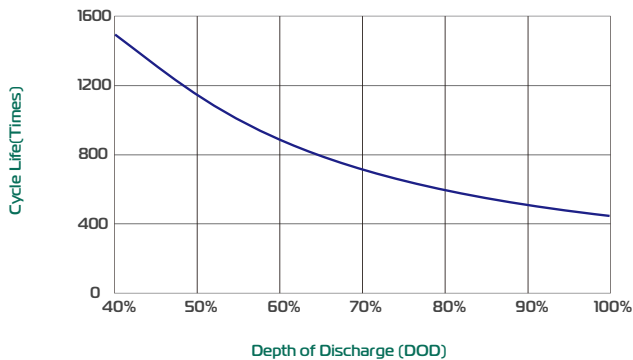

Cycle Life vs Remaining Capacity@25°C(77°F)

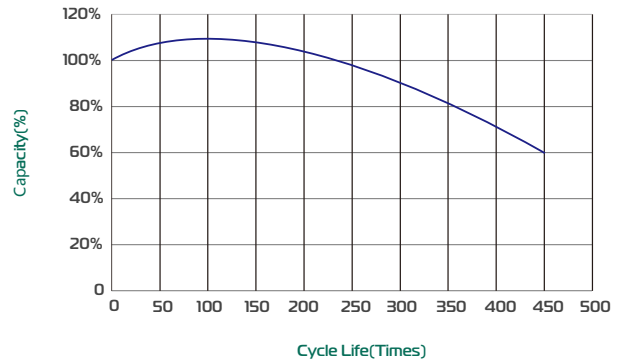

Usage and Maintenance

Limited Current	Limited Voltage	Floating Voltage
Limited current: $\leq 0.2C_2A$	14.75V-14.85V@25°C(77°F) Temp.Coefficient: -24mV/°C	13.7V-13.9V@25°C(77°F) Temp.Coefficient: -18mV/°C